

My Action Plan for Cascade Key

Are you feeling inspired to take action to address the traffic concerns on Cascade Key? Here is a checklist to help you get started:

- Talk to my neighbors and share the City’s findings and recommendations
- List interested neighbors who want to help me with efforts:

- Decide the educational programs we want to participate in:
 - Neighborhood Speed Watch
 - Radar Dolly
 - Sign and Pledge Program
- Contact City staff to set-up a training session and get materials

Notes:

More info

Find out more about these recommendations in our **Residential Traffic Guidebook** or by logging on to **Streets are for Everyone (SAFE)**—Neighborhood Traffic Safety Services’ blog.

Blog: <http://bellevuentss.wordpress.com>

Guidebook: http://www.bellevuewa.gov/pdf/Transportation/Guidebook_Web.pdf



TRAFFIC ACTION PLAN



2014-002 Cascade Key



April 16, 2014

Bellevue, WA 98006

Subject: Speeding Concerns on Cascade Key

Dear

Thank you for taking the time to share your concerns about speeding cars on Cascade Key in front of your home. Over the past few months, we have visited your street to watch traffic. You may also have noticed black tubes across the road that counted the cars traveling on your street and the speed they were going. We would like to share with you what we found and recommendations for addressing your concerns.

You mentioned in your request that a speed hump would help reduce vehicle speeds. The speed humps we install in Bellevue are designed for 25 mph speeds, but it does not guarantee that drivers will do so. Locations where we’ve installed speed humps have the majority of drivers speeding more than 10 mph over the posted speed limit. These guidelines have been established in part because speed humps can cause a delay between 1 and 9 seconds for emergency response, such as a fire engine responding to a fire. Speed studies were conducted in late February/early March as shown on page 2 of this report. From the speed studies conducted on Cascade Key, 85% of motorists were traveling at or below 30 mph in the northbound direction and at or below 29 mph in the southbound direction. The posted speed limit is 25 mph.

An interesting fact to share with you is that over the years, we have found most of the drivers speeding in neighborhoods are the local residents themselves. They are familiar with the streets and do not pay attention at times to how fast they are driving. Educating drivers about the speed limit is one way of addressing speeds in a neighborhood like Newport Shores. We have a number of programs that are available for participation for you, your parents, and other residents of Newport Shores. These are described in more detail on page 3 of this report. We would encourage you to talk with the Newport Shores Commodores about your concerns and ways they can become involved. They may be familiar with some of these programs as they have participated in past years, such as borrowing the Radar Dolly and the Sign and Pledge Program. We can even personalize the Sign and Pledge program with drawings from Newport Shores kids depicting safety messages.



Again, thank you for sharing your concerns with us. We look forward to working with you and your neighbors on the education programs suggested to address your traffic concerns. Please feel free to contact me at lglas@bellevuewa.gov or 425-452-2841 to participate in any of the education programs described in this Traffic Action Plan.

Sincerely,

Linda Glas

Linda Glas, P.E.

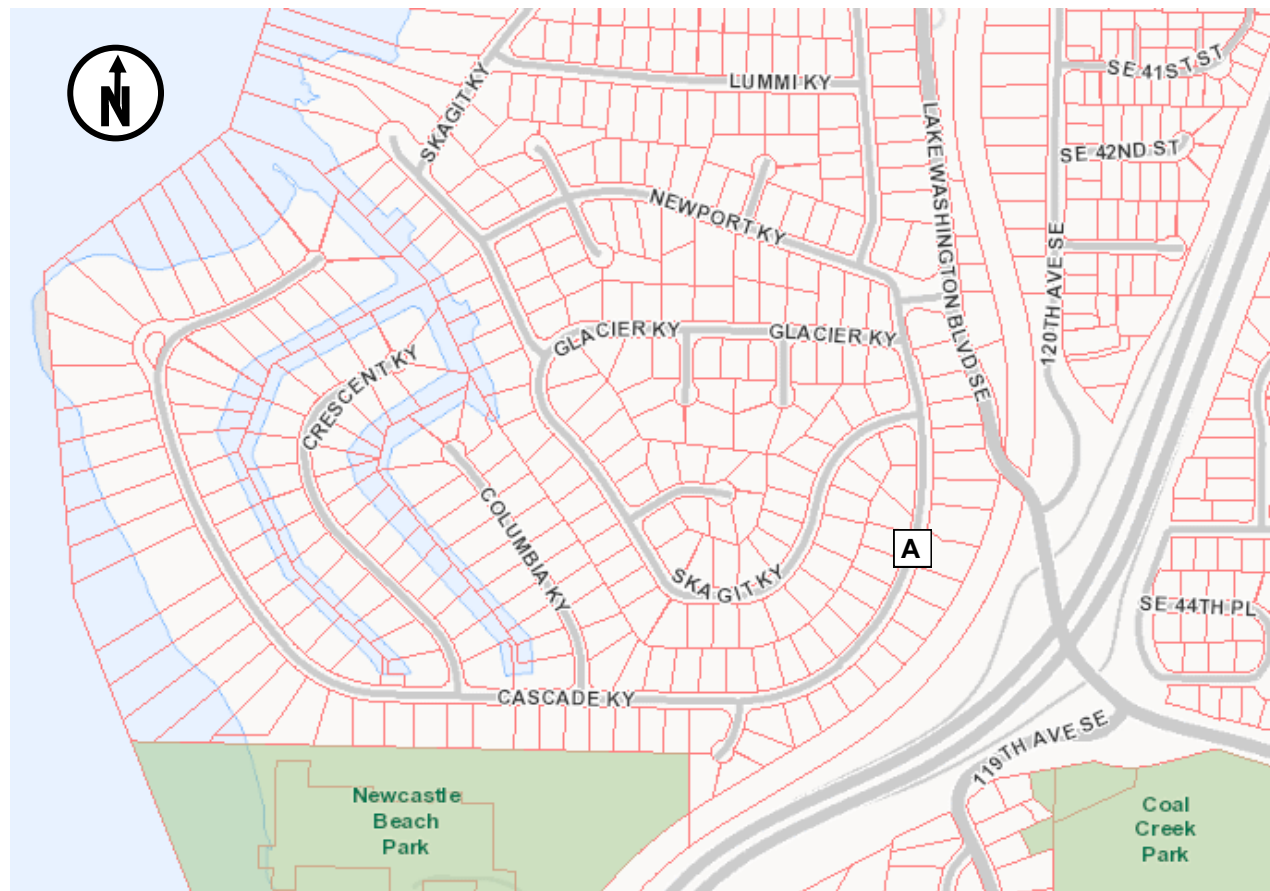

Summary of Findings

Date of Study	Location of Study	Average Daily Traffic	Average Speeds		85th% Speeds*	
			Northbound	Southbound	Northbound	Southbound
Feb/Mar 2014	A Cascade Key	1106	26	25	30	29

*85% of vehicles traveling at or below this speed



Customized Traffic Action Plan for Cascade Key

- Educate the Community
- Enhance Neighborhood Identity
- Reduce Excessive Vehicle Speeds

Education, Encouragement, and Enforcement

By educating the community and encouraging safe driving, we can begin to change driver behavior and reduce vehicle speeds.

Neighborhood Speed Watch

Using a borrowed radar unit, you record information about vehicles you observe traveling at or above 30 mph. NTSS staff then locate the registered owners of the vehicles and send a letter to them asking for their cooperation in reducing their speed. A partner to assist you with the data collection is recommended.

Radar Dolly

You can borrow and place a radar dolly on your street for up to two weeks. This unit gives motorists feedback on the speed at which they are driving, encouraging them to obey the speed limit. Should you like to borrow the radar dolly, please request it by calling (425) 452-6457 or sign up on www.bellevuewa.gov/radardolly.htm.

Sign and Pledge Program

This program involves lending communities portable signs that encourage motorists to respect the neighborhood, drive responsibly, and drive 25 mph. The signs are moved by community volunteers from place to place throughout the neighborhood every few days. The second part of the program is a neighborhood pace car program. Residents who pledge to drive responsibly and drive the speed limit on all neighborhood streets receive magnetic bumper stickers or window clings to place on their vehicles. As these motorists drive 25 mph on residential streets, they set the pace for drivers behind them.

